



GFA AIRWORTHINESS DIRECTIVE

- TYPE AFFECTED:** Pilatus B4-PC11, B4-PC11A and B4-PC11AF, all serial numbers.
- SUBJECT:** Inspection/replacement of control-column support on frame 2.
- BACKGROUND:** During inspections cracks have been found in the control-column support on frame 2. Failure of the support could lead to loss of control of the aircraft.
- DOCUMENTATION:** Issue 2 of this AD replaces Swiss Federal Office of Civil Aviation (FOCA) Airworthiness Directive HB 2003-199 with HB 2004-491 and Service Bulletin 1005 with SB 1005 REV 2, which now call for annual inspections. The SB is attached and forms part of this AD.
- These updates do not alter the Australian AD, as the requirement for annual inspection was already included, although the wording has been changed slightly for clarity.
- ACTIONS REQUIRED:**
1. In accordance with the Service Bulletin referred to above, inspect the control-column support for cracks, especially in the areas of the upper and lower bend angles where the support is attached to frame 2. **NO CRACKS ARE PERMITTED.** If no cracks are found, the aircraft may be returned to service immediately. If cracks are found the aircraft must be grounded until the support is replaced with a new part. The aircraft may then be returned to service.
 2. Repeat the above procedure at each Form 2 inspection.
- WEIGHT AND BALANCE:** Not affected.
- IMPLEMENTATION:**
- Action 1 - Before further flight, unless already accomplished under AD-589 Issue 1, within the last 12 months.
- Action 2 - At each Form 2 inspection.
- COMPLIANCE:** The requirements of this GFA Airworthiness Directive are mandatory. This Directive is issued pursuant to the Rules and Regulations of the Gliding Federation of Australia.

SIGNED:

SENIOR TECHNICAL OFFICER AIRWORTHINESS



For and on behalf of:

THE GLIDING FEDERATION
OF AUSTRALIA

SERVICE BULLETIN

SERVICE BULLETIN NO: 1005

REF NO:

MODIFICATION NO:

ATA CHAPTER: 53

FUSELAGE - GENERAL CONTROL COLUMN SUPPORT ON FRAME 2 - INSPECTION

1. Planning Information

A. Effectivity

- (1) All Pilatus B4-PC 11, B4-PC 11A and B4-PC 11AF glider aircraft (sailplane).

B. Concurrent Requirements

None

C. Reason

(1) Problem

Cracks can occur in the support to which the control-column is attached.

(2) Solution

Examine the support and replace it if cracked.

D. Description

This Service Bulletin gives the instructions necessary to inspect the support attached to the aft face of Frame 2 (FR 2).

Revision 1 to this Service Bulletin changes the Part Number of the support.

Revision 2 to this Service Bulletin adds the inspection to the Annual Servicing.

E. Compliance

Mandatory.

Required before the next flight and at each Annual Servicing.

NOTE: If a previous revision of this Service Bulletin has been accomplished, no further action is necessary until the next Annual Servicing.

F. Approval

The technical aspects of this Service Bulletin have been approved by the Federal Office for Civil Aviation (FOCA) of Switzerland as an Airworthiness Directive.

PILATUS advises Operators/Owners to check with their local Airworthiness Authorities for any changes, local regulations or sanctions that may affect the embodiment of this Service Bulletin.

G. Manpower

| | |
|------------------------|------------|
| | Total |
| Preparation | 0.25 |
| Inspection | 0.25 |
| TOTAL MAN-HOURS | 0.5 |

H. Weight and Balance

(1) Weight Change

Not affected.

(2) Moment Change

Not affected.

I. Electrical Load Data

Not changed.

J. Software

Not changed.

K. References

None.

L. Publications Affected

None.

M. Interchangeability of Parts

Not affected.

2. Material Information

A. Material - Price and Availability

Operators must speak to Pilatus for information on the price and availability of the support bracket:

PILATUS AIRCRAFT LTD.,
BU MAINTENANCE,
F. ODERMATT
CH-6371 STANS,
SWITZERLAND

Tel: + 41 41 619 6580
eMail: fodermatt@pilatus-aircraft.com

B. Material Necessary for Each Aircraft

(1) Material to be Procured

| New Part No. | Description | Old Part No. | Qty | Disp. Code | Fig | Item |
|---------------|-------------|---------------|-----|------------|-----|------|
| 112.35.11.072 | Support | 112.35.11.072 | A/R | D | 1 | 1 |

Disposition Codes: D - Discard / R - Return to Pilatus

There is one support 112.35.11.072 on each aircraft. It is necessary to send an order for the support only if the bracket is cracked.

3. Accomplishment Instructions - Aircraft

A. Preparation

- (1) Get access to the aft face of Frame 2 lower.

B. Inspection of the Support (Ref. Fig. 1)

- (1) Use a source of bright light and X10 magnifier and examine support (1) for cracks. Do this specially in the areas of the upper and lower bend angles where the support (1) is attached to Frame 2.
- (2) Cracks are not permitted in the support (1). Replace the support (1) if you find cracks.
- (3) Do the inspection again at each annual servicing.

C. Close up

- (1) Make sure the work area is clean and clear of tools and other items.

D. Documentation

- (1) Make an entry in the Aircraft Logbook that this Service Bulletin has been incorporated.

PILATUS
B4-PC 11

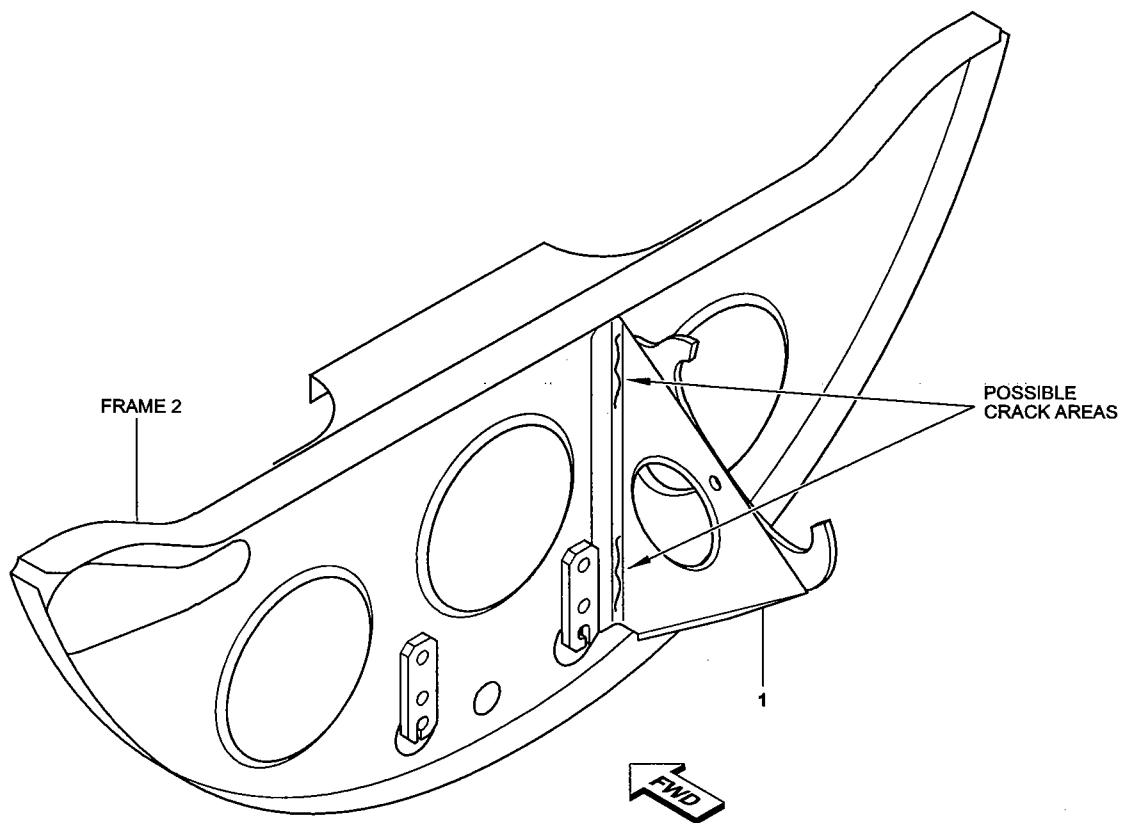

Support Frame 2 - Inspection
Figure 1